

KEY PLAN

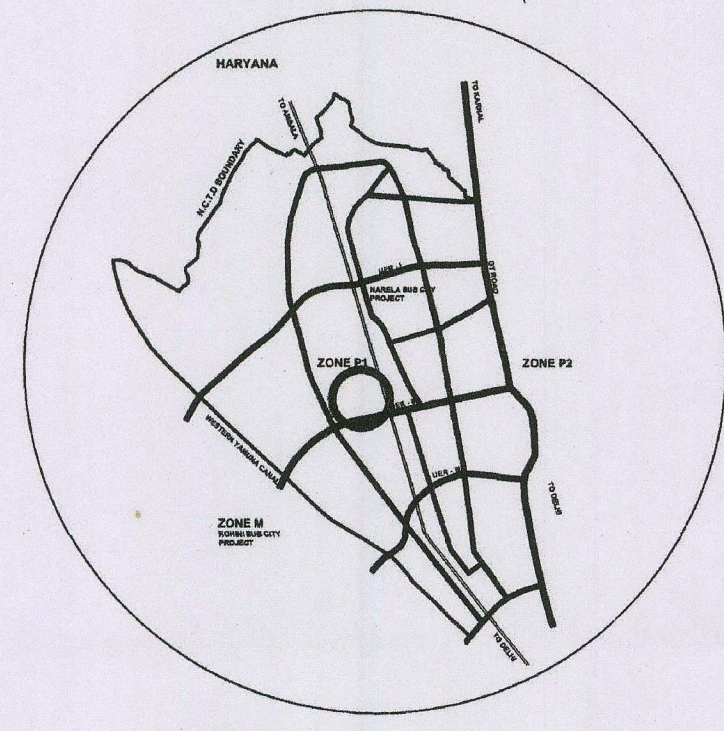

LEGEND

- RESIDENTIAL
- UTILITIES
- COMMERCIAL
- PUBLIC/ SEMI PUBLIC FACILITIES
- MASTER PLAN GREEN
- GREEN BUFFER
- SECTOR BOUNDARY

DELHI DEVELOPMENT AUTHORITY
HUPW-COORDINATION UNIT

VERIFIED
THIS PROPOSAL WAS CONSIDERED IN THE
264th SCREENING COMMITTEE MEETING
HELD ON-02.05.2008 VIDE ITEM NO. 49:2008
SD/= DY DIRECTOR(ARCH) COORD

DELHI DEVELOPMENT AUTHORITY
CERTIFIED
APPROVED IN 264th. SCREENING COMMITTEE
MEETING DT. 02-05-2008 VIDE ITEM NO. 49:2008
SIGN: SD/= NAME: N.K. CHAKRABORTY
DIRECTOR (NP)

DELHI DEVELOPMENT AUTHORITY
HUPW-COORDINATION UNIT
VERIFIED
THIS PROPOSAL WAS CONSIDERED IN THE
300th SCREENING COMMITTEE MEETING
HELD ON-08.06.11 VIDE ADDITIONAL ITEM
NO. 81:2011 SD/= DY DIRECTOR(ARCH) COORD

DELHI DEVELOPMENT AUTHORITY
CERTIFIED
APPROVED IN 300th SCREENING COMMITTEE
MEETING DT. 08.06.11 VIDE ADDITIONAL ITEM
NO. 81:2011 SIGN: SD/= DIRECTOR (NP)

DELHI DEVELOPMENT AUTHORITY

LANDUSE DISTRIBUTION (ZONAL LEVEL)

(AS PER ZDP)	(IN HACT)	(%)
1.GROSS RESIDENTIAL	151.02	48.895
2.COMMERCIAL	32.54	10.535
3.MANUFACTURING	NIL	0.00
4.PUBLIC & SEMI PUBLIC	NIL	0.00
5.RECREATIONAL	99.75	32.296
6.TRANSPORTATION	21.54	6.976
7.UTILITY	4.01	1.2988
TOTAL AREA	308.86	100

PROPOSED POPULATION @500 PPH = 75,510 PERSONS
TOTAL DWELLING UNIT @5 PERSONS/ DWELLING =15,102

● GROSS RESIDENTIAL AREA INCLUDES THE AREA OF EXISTING SLUM & JJ SCHEME 38.78 Hac AND VILLAGE HOLAMBI KALAN 25.54 Hac HAVING 17,944 DUs AS PER THE LOP OF METRO VIHAR AND THE CENSUS POPULATION 2001 FOR VILLAGE HOLAMBI KALAN.

DISTRIBUTION OF GROSS RESIDENTIAL AREA

	(IN HACT)	(%)
1. NET RESIDENTIAL	91.33	60.475
● AREA UNDER VILLAGE AND JJ SCHEME	64.32	42.590
● AREA UNDER NEW RESIDENTIAL DEVELOPMENT	27.01	17.885
2. COMMERCIAL	5.39	3.569
3. PUBLIC/ S. PUBLIC	11.43	7.568
4. RECREATIONAL	20.48	13.563
5. CIRCULATION	22.39	14.825
TOTAL AREA	151.02	100

CONSIDERING THE EXISTING DEVELOPMENT AND NO. OF DUs AT SITE i.e. 10596 DUs, THE TOTAL NO. OF DUs PROPOSED / PROJECTED ARE 15,102. AREA OF PATHWAY IS INCLUDED IN CIRCULATION AREA.

DISTRIBUTION OF FACILITIES(AS PER M.P.D. 2021)

	NO.
1. PRIMARY /MIDDLE SCHOOL	7
2. SR. SECONDARY SCHOOL	7
3. RELIGIOUS BUILDINGS	14
4. ESS 11KV	7
5. BANQUET HALLS	7
6. THREE WHEELER/ TAXI STAND	7
7. UNDER GROUND TANKS	7
8. SEWAGE PUMPING STATION	7
9. COACHING CENTRES,IT&LANGUAGES	7
10. DHALAO	7
11. DISPENSARY	7
12. WATER TREATMENT FACILITY	AS PER REQUIREMENT
13. ANGANWADI	14
14. MILK BOOTH	AS PER REQUIREMENT
15. CONVENIENCE SHOPPING	14
16. LOCAL SHOPPING	7
17. SERVICE MARKET	7
18. INFORMAL BAZAR	7
19. HOUSING AREA PARK	14
20. HOUSING AREA PLAYGROUND	14
21. NEIGHBOURHOOD PARK	7
22. NEIGHBOURHOOD PLAY AREA	7

NOTE:
THE LAYOUT PLAN IS BASED ON THE SURVEY SUPPLIED BY THE EXECUTIVE ENGINEER N.D.12 VIDE HIS LETTER DATED ON MARCH 2007 IN FILE NO. F-3 (33)/ 2007 / MP

1. The Proposal for Sr. Sec. School under Right to Education Act is prepared on the basis of PT Survey and dimensions as per measurements (F9(01)2011/MP)

2. The proposal of Sr. Secondary School site in sector G3 & G4 Narela under Right to Education Act (RTE Act) is approved in 300th screening committee meeting held on 08.08.11 vide additional item no. 81:2011. (File No. F9(01)2011/MP)

TITLE: DRAFT COMPOSITE LAYOUT PLAN OF SECTOR G-3, G-4 OF NARELA SUBCITY

SCALE: 100m 0 200m	DATE: 14/03/2008	DEALT BY:	DRAWING NO.: 488
PLG. DIMAN:	PLG. ASST.:	ASST. DIR.:	JT.DIR.(PLG.)
(N.K. CHAKRABORTY) DIRECTOR(PLG.)	(ASHOK KUMAR) ADDL.COMMR. (PLG.)	(A.K. JAIN) COMMR. (PLG.):	NORTH:

NARELA PROJECT DDA PLANNING UNIT

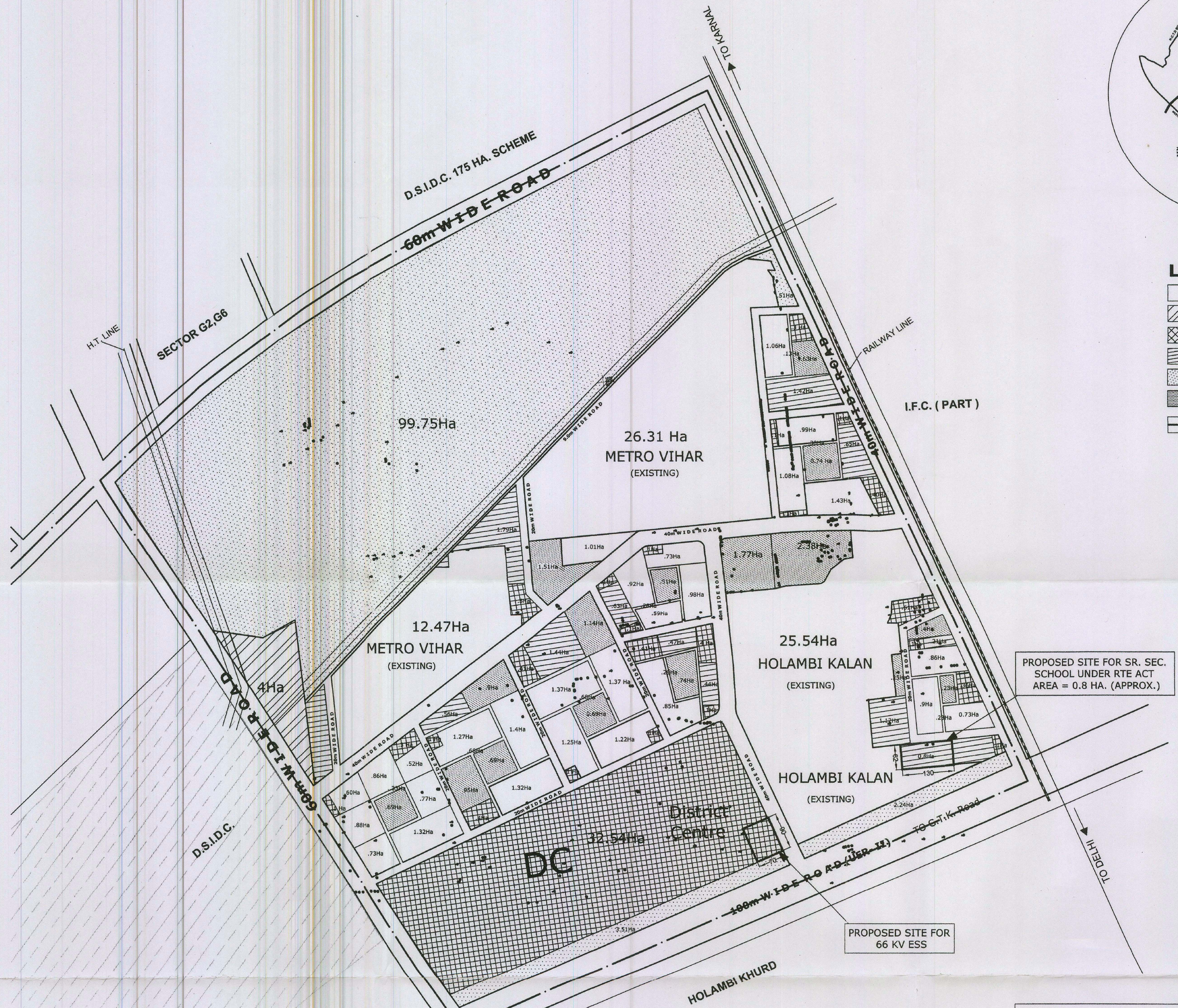

Note:

- The agenda for Earmarking of additional 66 KV ESS in the Layout plan of Sectors G7, G8, G2, G6, G3 & G4 in Zone P-I was discussed in the 309th Screening Committee meeting held on 29.10.12 vide item no. 125:2012. The S.C. has approved and recommended the proposal for consideration of the Authority under sub-Clause: 8(2)/Permission of use premises in Use Zones of MPD-2021. (In File F3(01)/2009-MP)
- The agenda was prepared on the basis of feasibility submitted by EE/ND-12 and EE/ND-9. (In File F3(01)/2009-MP)
- The agenda was considered & approved in the Authority meeting held on 11.12.2012 vide item no. 88/12. (In File F3(01)/2009-MP)
- Modification has been done on the LOP as available in the record.

CRINKOO M. (JAN)
PLG. ASSTT.
ASST. DIR. (PLG.)
DIR.(PLG.) in-charge

DELHI DEVELOPMENT AUTHORITY
HUPW-COORDINATION UNIT
VERIFIED
This proposal was considered in the
309th Screening Committee
Meeting held on 29.10.12
vide item no. 125:2012
By Director (Arch.) Coord

DELHI DEVELOPMENT AUTHORITY
Approved in 309th Screening Committee
Meeting Held on 29.10.12 vide item no. 125:2012
Director (N.P.)

DELHI DEVELOPMENT AUTHORITY
HUPW-COORDINATION UNIT
VERIFIED
This proposal was considered in the
310th Screening Committee
Meeting held on 20.12.12
vide item no. 137:2012
By Director (Arch.) Coord