



AREA STATEMENT

- A. TOTAL AREA OF PLOT 12.13 HA.
- AREA UNDER
1. RESIDENTIAL PLOTS 5.26 HA. (43.4%)
2. CIRCULATION/PARKING 4.95 HA. (40.8%)
3. OPEN GRASS/GREEN 1.66 HA. (13.6%)
4. UTILITY/FACILITY 0.26 HA. (2.1%)
- B. DISTRIBUTION OF RESIDENTIAL PLOTS

Plot No.	Total Area	Net Area	Net Plot	Plot Area
1	600.50	364.00	1456	6552
2	600.50	364.00	1456	6552

Plot No.	Total Area	Net Area	Net Plot	Plot Area
3	600.50	364.00	1456	6552
4	600.50	364.00	1456	6552

Plot No.	Total Area	Net Area	Net Plot	Plot Area
5	600.50	364.00	1456	6552
6	600.50	364.00	1456	6552

Plot No.	Total Area	Net Area	Net Plot	Plot Area
7	600.50	364.00	1456	6552
8	600.50	364.00	1456	6552

Plot No.	Total Area	Net Area	Net Plot	Plot Area
9	600.50	364.00	1456	6552
10	600.50	364.00	1456	6552

Plot No.	Total Area	Net Area	Net Plot	Plot Area
11	600.50	364.00	1456	6552
12	600.50	364.00	1456	6552

Plot No.	Total Area	Net Area	Net Plot	Plot Area
13	600.50	364.00	1456	6552
14	600.50	364.00	1456	6552

Plot No.	Total Area	Net Area	Net Plot	Plot Area
15	600.50	364.00	1456	6552
16	600.50	364.00	1456	6552

Plot No.	Total Area	Net Area	Net Plot	Plot Area
17	600.50	364.00	1456	6552
18	600.50	364.00	1456	6552

Plot No.	Total Area	Net Area	Net Plot	Plot Area
19	600.50	364.00	1456	6552
20	600.50	364.00	1456	6552

Plot No.	Total Area	Net Area	Net Plot	Plot Area
21	600.50	364.00	1456	6552
22	600.50	364.00	1456	6552

Plot No.	Total Area	Net Area	Net Plot	Plot Area
23	600.50	364.00	1456	6552
24	600.50	364.00	1456	6552

Plot No.	Total Area	Net Area	Net Plot	Plot Area
25	600.50	364.00	1456	6552
26	600.50	364.00	1456	6552

Plot No.	Total Area	Net Area	Net Plot	Plot Area
27	600.50	364.00	1456	6552
28	600.50	364.00	1456	6552

Plot No.	Total Area	Net Area	Net Plot	Plot Area
29	600.50	364.00	1456	6552
30	600.50	364.00	1456	6552

Plot No.	Total Area	Net Area	Net Plot	Plot Area
31	600.50	364.00	1456	6552
32	600.50	364.00	1456	6552

Plot No.	Total Area	Net Area	Net Plot	Plot Area
33	600.50	364.00	1456	6552
34	600.50	364.00	1456	6552

Plot No.	Total Area	Net Area	Net Plot	Plot Area
35	600.50	364.00	1456	6552
36	600.50	364.00	1456	6552

Plot No.	Total Area	Net Area	Net Plot	Plot Area
37	600.50	364.00	1456	6552
38	600.50	364.00	1456	6552

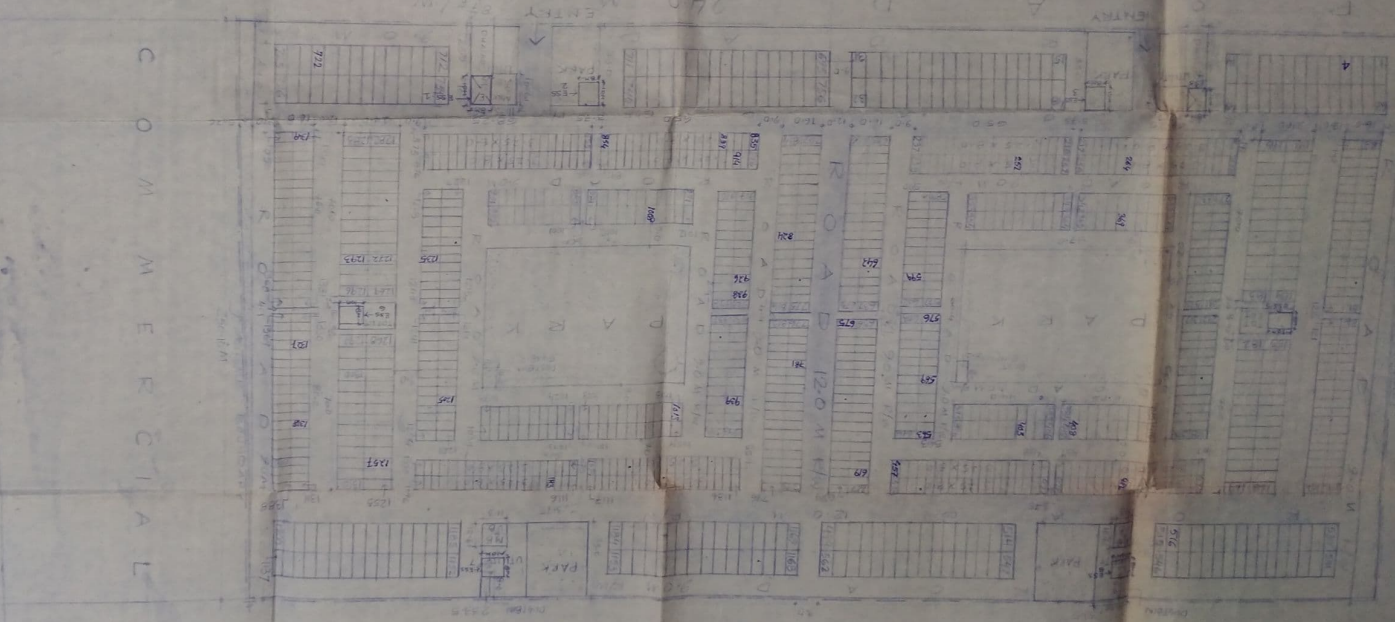

LEGEND

NOTE: BASE OF ALL ELS SITES MEASURING 100 X 100 M.
GROSS (100) METERS TO GROUND VERT LINES.
H.F. 1.3 (12) 12/11/1985 DT. 12.09.2014.

THE SCHEME WAS DISCUSSED IN THE 28TH SCREENING COMMITTEE MEETING HELD ON 25.04.2012. THE COMMITTEE HAS APPROVED THE SCHEME. THE SCHEME WAS APPROVED IN 28TH SCREENING COMMITTEE MEETING HELD ON 25.04.2012 AND THE SAME WAS APPROVED BY D.D. (A&S) (GODAN) DT. 6-4-10 IN FILE NO. D.D. (A&S) (R/1039)/P&T 5/BLK-C/2010.

THE SCHEME WAS DISCUSSED IN THE 28TH SCREENING COMMITTEE MEETING HELD ON 25.04.2012. THE COMMITTEE HAS APPROVED THE SCHEME. THE SCHEME WAS APPROVED IN 28TH SCREENING COMMITTEE MEETING HELD ON 25.04.2012 AND THE SAME WAS APPROVED BY D.D. (A&S) (GODAN) DT. 6-4-10 IN FILE NO. D.D. (A&S) (R/1039)/P&T 5/BLK-C/2010.

THE SCHEME WAS DISCUSSED IN THE 28TH SCREENING COMMITTEE MEETING HELD ON 25.04.2012. THE COMMITTEE HAS APPROVED THE SCHEME. THE SCHEME WAS APPROVED IN 28TH SCREENING COMMITTEE MEETING HELD ON 25.04.2012 AND THE SAME WAS APPROVED BY D.D. (A&S) (GODAN) DT. 6-4-10 IN FILE NO. D.D. (A&S) (R/1039)/P&T 5/BLK-C/2010.

THE SCHEME WAS DISCUSSED IN THE 28TH SCREENING COMMITTEE MEETING HELD ON 25.04.2012. THE COMMITTEE HAS APPROVED THE SCHEME. THE SCHEME WAS APPROVED IN 28TH SCREENING COMMITTEE MEETING HELD ON 25.04.2012 AND THE SAME WAS APPROVED BY D.D. (A&S) (GODAN) DT. 6-4-10 IN FILE NO. D.D. (A&S) (R/1039)/P&T 5/BLK-C/2010.

THE SCHEME WAS DISCUSSED IN THE 28TH SCREENING COMMITTEE MEETING HELD ON 25.04.2012. THE COMMITTEE HAS APPROVED THE SCHEME. THE SCHEME WAS APPROVED IN 28TH SCREENING COMMITTEE MEETING HELD ON 25.04.2012 AND THE SAME WAS APPROVED BY D.D. (A&S) (GODAN) DT. 6-4-10 IN FILE NO. D.D. (A&S) (R/1039)/P&T 5/BLK-C/2010.